

160/600M

Deep Groove Ball Bearings (single row, metric)



Details:

Main dimensions

d [mm]	600	d ₁ [mm]	≈ 695.6
D [mm]	870	D ₁ [mm]	≈ 775.6
B [mm]	85	r _{1,2} [mm]	6
Weight [kg]	≈ 183		

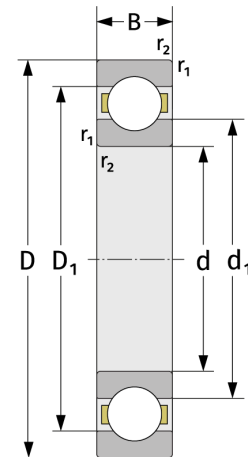
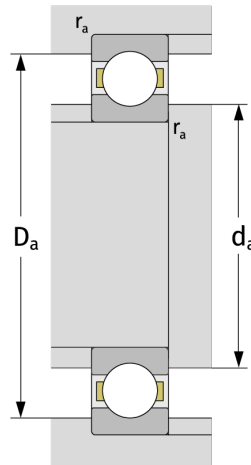

Mating dimensions

d _{a,min} [mm]	623
D _{a,max} [mm]	847
r _{a,max} [mm]	5

Calculation data

C [kN]	610
C ₀ [kN]	1260
C _u [kN]	22.8
n _{th} [min ⁻¹]	797
n _g [min ⁻¹]	1100
f ₀	16,4