

6056M

Deep Groove Ball Bearings (single row, metric)



Details:

Main dimensions

d [mm]	280	d ₁ [mm]	≈ 323.4
D [mm]	420	D ₁ [mm]	≈ 377.4
B [mm]	65	r _{1,2} [mm]	4
Weight [kg]	≈ 32.3		

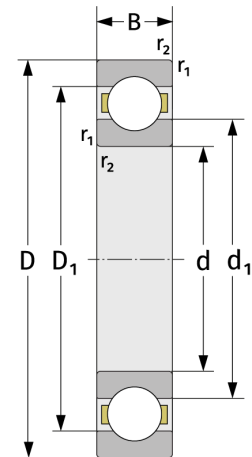
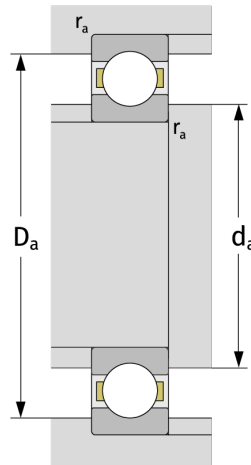

Mating dimensions

d _{a, min} [mm]	295
D _{a, max} [mm]	405
r _{a, max} [mm]	3

Calculation data

C [kN]	322
C ₀ [kN]	436
C _u [kN]	11.6
n _{th} [min ⁻¹]	2076
n _g [min ⁻¹]	2600
f ₀	15,8