

608/1060M

Deep Groove Ball Bearings (single row, metric)



Details:

Main dimensions

d [mm]	1060	d ₁ [mm]	≈
D [mm]	1280		1138.5
B [mm]	71	D ₁ [mm]	≈
Weight [kg]	≈ 198		1202.5
		r _{1,2} [mm]	5

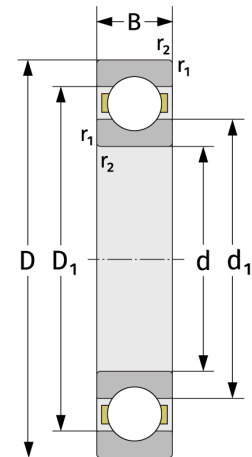
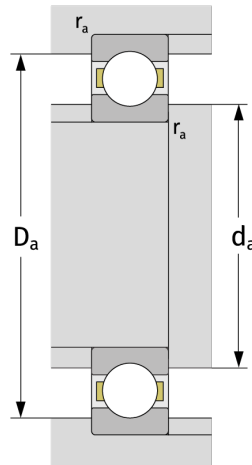

Mating dimensions

d _{a,min} [mm]	1078
D _{a,max} [mm]	1262
r _{a,max} [mm]	4

Calculation data

C [kN]	590
C ₀ [kN]	1530
C _u [kN]	21.6
n _{th} [min ⁻¹]	410
n _g [min ⁻¹]	560
f ₀	15,6