

609/600M

Deep Groove Ball Bearings (single row, metric)



Details:

Main dimensions

d [mm]	600	d ₁ [mm]	≈ 670.5
D [mm]	800	D ₁ [mm]	≈ 730.5
B [mm]	63	r _{1,2} [mm]	5
Weight [kg]	≈ 96.2		

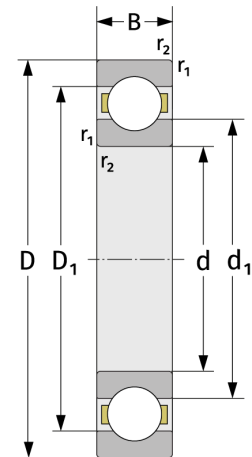
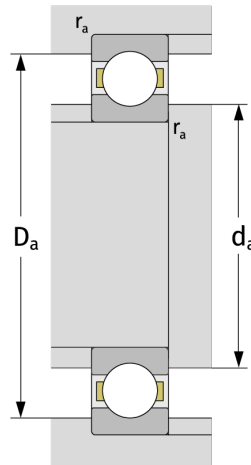

Mating dimensions

d _{a,min} [mm]	618
D _{a,max} [mm]	782
r _{a,max} [mm]	4

Calculation data

C [kN]	473
C ₀ [kN]	950
C _u [kN]	17.6
n _{th} [min ⁻¹]	799
n _g [min ⁻¹]	1200
f ₀	16,1