

60922M

Deep Groove Ball Bearings (single row, metric)



Details:

Main dimensions

d [mm]	110	d_1 [mm]	≈ 124.1
D [mm]	150	D_1 [mm]	≈ 136.1
B [mm]	13	$r_{1,2}$ [mm]	0.6
Weight [kg]	≈ 0.733		

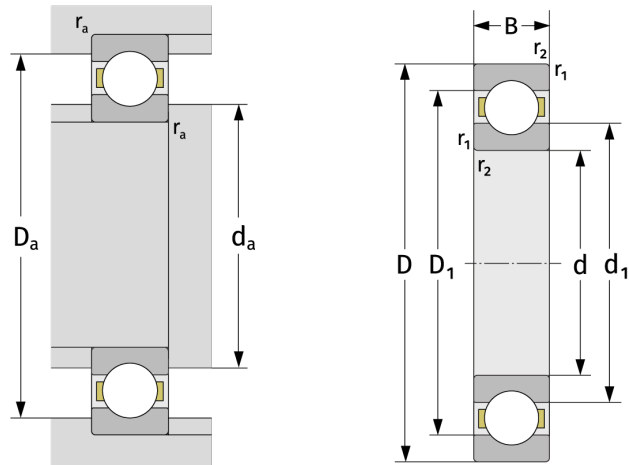

Mating dimensions

$d_{a, \min}$ [mm]	113
$D_{a, \max}$ [mm]	147
$r_{a, \max}$ [mm]	0.6

Calculation data

C [kN]	32.4
C_0 [kN]	35.2
C_u [kN]	1.58
n_{th} [min^{-1}]	3452
n_g [min^{-1}]	7400
f_0	16,2