

618/1000M

Deep Groove Ball Bearings (single row, metric)



Details:

Main dimensions			
d [mm]	1000	d ₁ [mm]	≈ 1070.6
D [mm]	1220	D ₁ [mm]	≈ 1150.6
B [mm]	100	r _{1,2} [mm]	6
Weight [kg]	≈ 248		

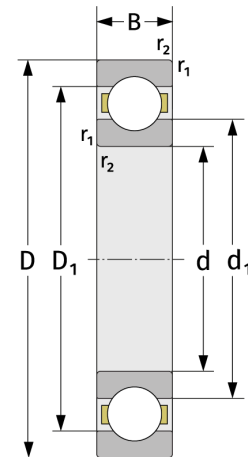
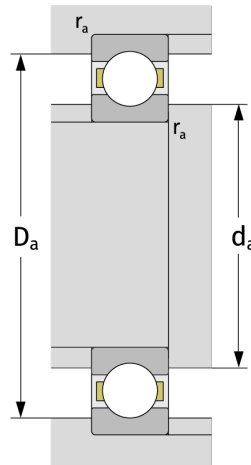

Mating dimensions		Calculation data	
d _{a,min} [mm]	1023	C [kN]	745
D _{a,max} [mm]	1197	C ₀ [kN]	1920
r _{a,max} [mm]	5	C _u [kN]	27.9
		n _{th} [min ⁻¹]	499
		n _g [min ⁻¹]	610
		f ₀	15,8