

# 618/600M

Deep Groove Ball Bearings (single row, metric)



## Details:

### Main dimensions

d [mm]	600	d <sub>1</sub> [mm]	≈ 641.4
D [mm]	730	D <sub>1</sub> [mm]	≈ 689.4
B [mm]	60	r <sub>1,2</sub> [mm]	3
Weight [kg]	≈ 52.6		

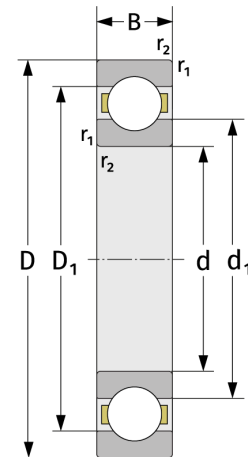
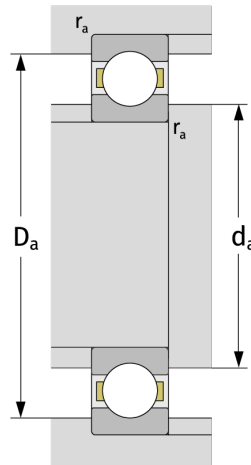

### Mating dimensions

d <sub>a,min</sub> [mm]	612
D <sub>a,max</sub> [mm]	718
r <sub>a,max</sub> [mm]	2.5

### Calculation data

C [kN]	364
C <sub>0</sub> [kN]	695
C <sub>u</sub> [kN]	13.2
n <sub>th</sub> [min <sup>-1</sup> ]	855
n <sub>g</sub> [min <sup>-1</sup> ]	1300
f <sub>0</sub>	15,8