

618/630M

Deep Groove Ball Bearings (single row, metric)



Details:

Main dimensions

d [mm]	630	d ₁ [mm]	≈ 677.4
D [mm]	780	D ₁ [mm]	≈ 733.5
B [mm]	69	r _{1,2} [mm]	4
Weight [kg]	≈ 74.1		

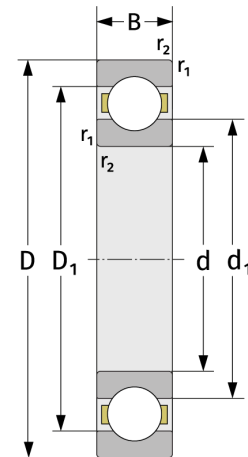
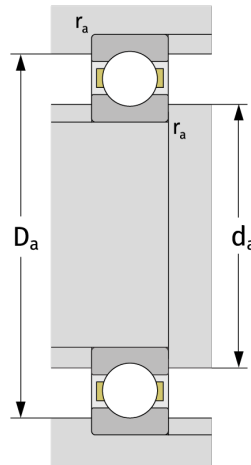

Mating dimensions

d _{a,min} [mm]	645
D _{a,max} [mm]	765
r _{a,max} [mm]	3

Calculation data

C [kN]	442
C ₀ [kN]	885
C _u [kN]	16.3
n _{th} [min ⁻¹]	825
n _g [min ⁻¹]	1200
f ₀	16