

618/710M

Deep Groove Ball Bearings (single row, metric)



Details:

Main dimensions			
d [mm]	710	d ₁ [mm]	≈ 760.5
D [mm]	870	D ₁ [mm]	≈ 820.5
B [mm]	74	r _{1,2} [mm]	4
Weight [kg]	≈ 94.7		

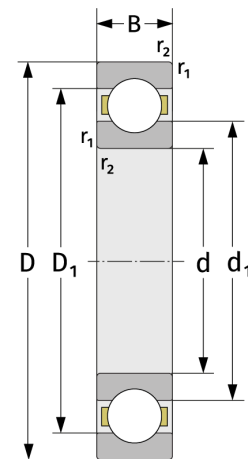
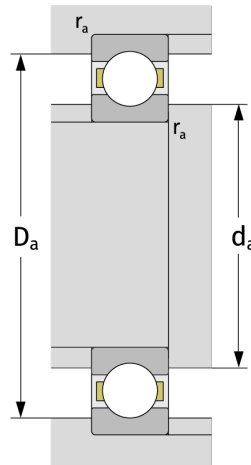

Mating dimensions		Calculation data	
d _{a,min} [mm]	725	C [kN]	481
D _{a,max} [mm]	855	C ₀ [kN]	1020
r _{a,max} [mm]	3	C _u [kN]	17.6
		n _{th} [min ⁻¹]	723
		n _g [min ⁻¹]	970
		f ₀	15,9