

61820M

Deep Groove Ball Bearings (single row, metric)

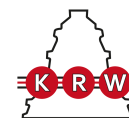

Details:

Main dimensions

d [mm]	100	d ₁ [mm]	≈ 108.1
D [mm]	125	D ₁ [mm]	≈ 117.1
B [mm]	13	r _{1,2} [mm]	1
Weight [kg]	≈ 0.362		

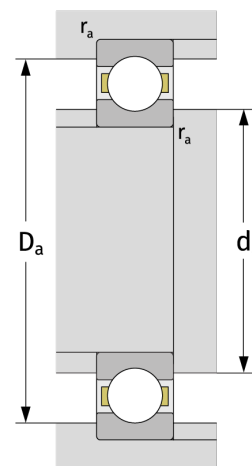
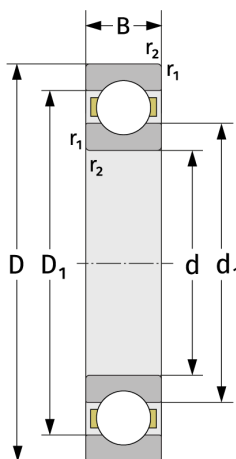

Mating dimensions

d _{a, min} [mm]	105
D _{a, max} [mm]	120
r _{a, max} [mm]	1

Calculation data

C [kN]	20.1
C ₀ [kN]	22.1
C _u [kN]	1.07
n _{th} [min ⁻¹]	4137
n _g [min ⁻¹]	8600
f ₀	16