

# 619/670M

Deep Groove Ball Bearings (single row, metric)



## Details:

### Main dimensions

d [mm]	670	d <sub>1</sub> [mm]	≈ 743.7
D [mm]	900	D <sub>1</sub> [mm]	≈ 827.7
B [mm]	103	r <sub>1,2</sub> [mm]	6
Weight [kg]	≈ 190		

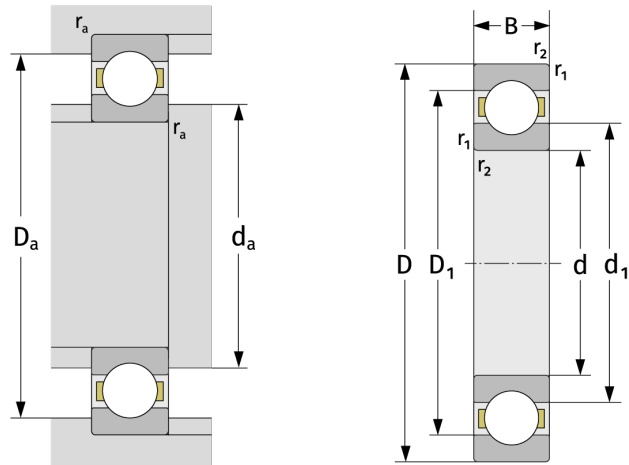

### Mating dimensions

d <sub>a,min</sub> [mm]	693
D <sub>a,max</sub> [mm]	877
r <sub>a,max</sub> [mm]	5

### Calculation data

C [kN]	675
C <sub>0</sub> [kN]	1460
C <sub>u</sub> [kN]	25.5
n <sub>th</sub> [min <sup>-1</sup> ]	781
n <sub>g</sub> [min <sup>-1</sup> ]	980
f <sub>0</sub>	16,4