

61934M

Deep Groove Ball Bearings (single row, metric)



Details:

Main dimensions			
d [mm]	170	d ₁ [mm]	≈ 188.7
D [mm]	230	D ₁ [mm]	≈ 211.7
B [mm]	28	r _{1,2} [mm]	2
Weight [kg]	≈ 3.4		

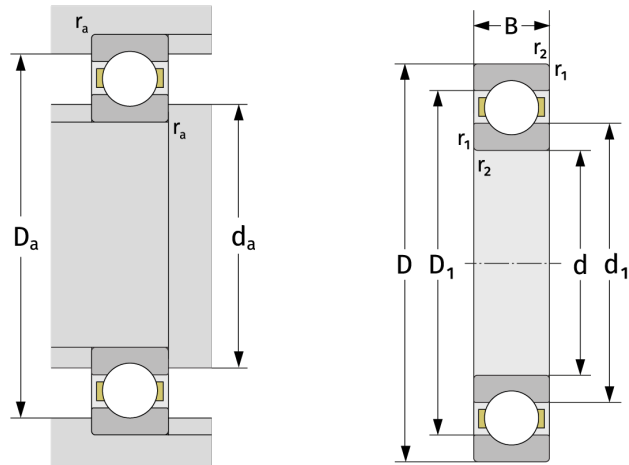

Mating dimensions		Calculation data	
d _{a,min} [mm]	179	C [kN]	94.2
D _{a,max} [mm]	221	C ₀ [kN]	105
r _{a,max} [mm]	2	C _u [kN]	3.75
		n _{th} [min ⁻¹]	3171
		n _g [min ⁻¹]	4700
		f ₀	16,5