

61952M

Deep Groove Ball Bearings (single row, metric)



Details:

Main dimensions			
d [mm]	260	d ₁ [mm]	≈ 291.3
D [mm]	360	D ₁ [mm]	≈ 329.3
B [mm]	46	r _{1,2} [mm]	2.1
Weight [kg]	≈ 14.5		

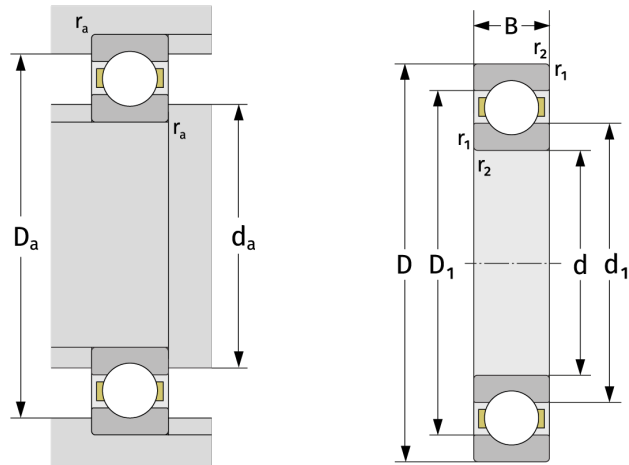

Mating dimensions		Calculation data	
d _{a,min} [mm]	270	C [kN]	213
D _{a,max} [mm]	350	C ₀ [kN]	269
r _{a,max} [mm]	2.1	C _u [kN]	7.64
		n _{th} [min ⁻¹]	2197
		n _g [min ⁻¹]	3000
		f ₀	16,4