

629/1000M

Deep Groove Ball Bearings (single row, metric)



Details:

Main dimensions

d [mm]	1000	d ₁ [mm]	≈
D [mm]	1320		1102.9
B [mm]	185	D ₁ [mm]	≈
Weight [kg]	≈ 666		1218.9
		r _{1,2} [mm]	7.5

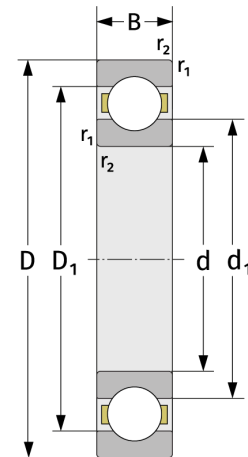
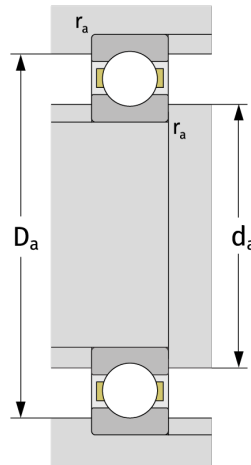

Mating dimensions

d _{a, min} [mm]	1028
D _{a, max} [mm]	1292
r _{a, max} [mm]	6

Calculation data

C [kN]	1110
C ₀ [kN]	3040
C _u [kN]	43.3
n _{th} [min ⁻¹]	557
n _g [min ⁻¹]	570
f ₀	16,3