

629/950M

Deep Groove Ball Bearings (single row, metric)



Details:

Main dimensions

d [mm]	950	d ₁ [mm]	≈
D [mm]	1250		1044.9
B [mm]	175	D ₁ [mm]	≈
Weight [kg]	≈ 557		1156.9
		r _{1,2} [mm]	7.5

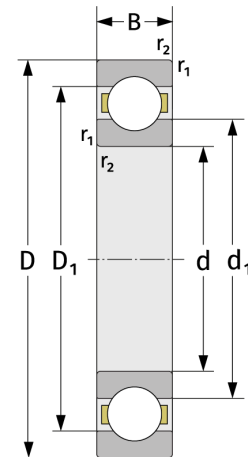
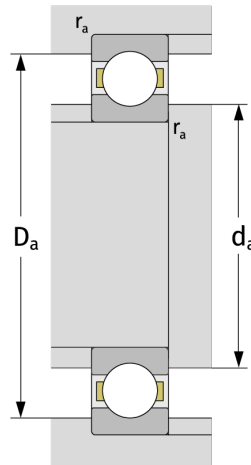

Mating dimensions

d _{a,min} [mm]	978
D _{a,max} [mm]	1222
r _{a,max} [mm]	6

Calculation data

C [kN]	1030
C ₀ [kN]	2710
C _u [kN]	39.7
n _{th} [min ⁻¹]	591
n _g [min ⁻¹]	610
f ₀	16,3