

62952M

Deep Groove Ball Bearings (single row, metric)



Details:

Main dimensions

d [mm]	260	d ₁ [mm]	≈ 291.3
D [mm]	360	D ₁ [mm]	≈ 329.3
B [mm]	60	r _{1,2} [mm]	2.1
Weight [kg]	≈ 17.8		

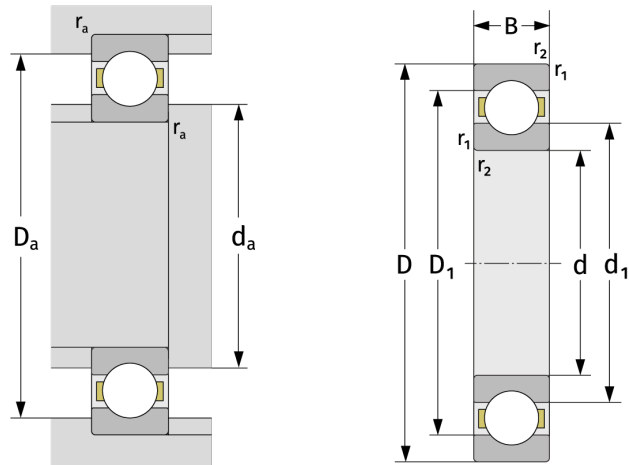

Mating dimensions

d _{a,min} [mm]	270
D _{a,max} [mm]	350
r _{a,max} [mm]	2.1

Calculation data

C [kN]	213
C ₀ [kN]	269
C _u [kN]	7.64
n _{th} [min ⁻¹]	2454
n _g [min ⁻¹]	3000
f ₀	16,4