

6440M

Deep Groove Ball Bearings (single row, metric)



Details:

Main dimensions

d [mm]	200	d ₁ [mm]	≈ 292.8
D [mm]	480	D ₁ [mm]	≈ 388.8
B [mm]	102	r _{1,2} [mm]	6
Weight [kg]	≈ 104		

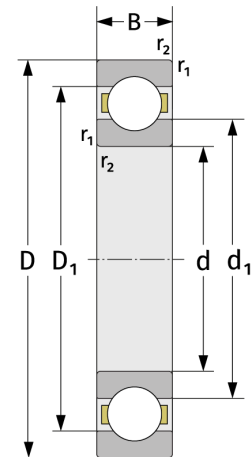
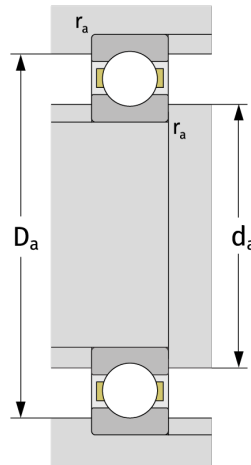

Mating dimensions

d _{a,min} [mm]	230
D _{a,max} [mm]	450
r _{a,max} [mm]	5

Calculation data

C [kN]	488
C ₀ [kN]	625
C _u [kN]	16.9
n _{th} [min ⁻¹]	2061
n _g [min ⁻¹]	2700
f ₀	13,4