

7256B.MP

Angular Contact Ball Bearings (single row, metric)



Details:

Main dimensions

d [mm]	280	D_1 [mm]	≈ 418.8
D [mm]	500	$r_{1,2}$ [mm]	5
B [mm]	80	$r_{3,4}$ [mm]	2
Weight [kg]	≈ 69.3	α_0 [°]	40
d_1 [mm]	≈ 367.3	a [mm]	≈ 204

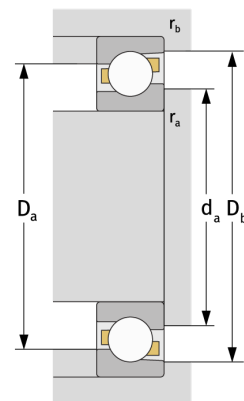
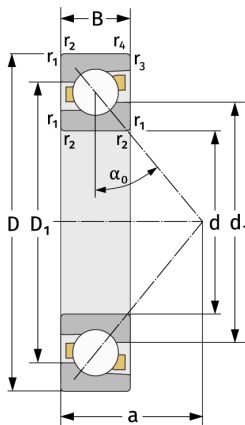

Mating dimensions

Calculation data

$d_{a, \min}$ [mm]	300	C [kN]	510
$D_{a, \max}$ [mm]	480	C_0 [kN]	830
$D_{b, \max}$ [mm]	489	C_u [kN]	20.9
$r_{a, \max}$ [mm]	4	n_{th} [min ⁻¹]	1343
$r_{b, \max}$ [mm]	2	n_g [min ⁻¹]	1600