

7264B.MP

Angular Contact Ball Bearings (single row, metric)



Details:

Main dimensions

d [mm]	320	D_1 [mm]	≈ 484.5
D [mm]	580	$r_{1,2}$ [mm]	5
B [mm]	92	$r_{3,4}$ [mm]	2
Weight [kg]	≈ 109	α_0 [°]	40
d_1 [mm]	≈ 422.8	a [mm]	≈ 235

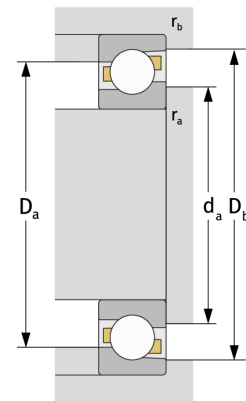
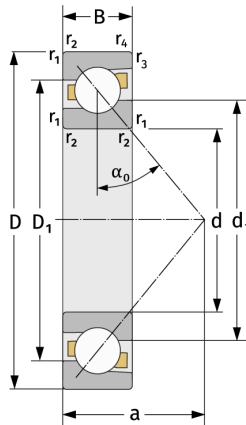

Mating dimensions		Calculation data	
$d_{a, \min}$ [mm]	340	C [kN]	635
$D_{a, \max}$ [mm]	560	C_0 [kN]	1120
$D_{b, \max}$ [mm]	569	C_u [kN]	26
$r_{a, \max}$ [mm]	4	n_{th} [min ⁻¹]	1118
$r_{b, \max}$ [mm]	2	n_g [min ⁻¹]	1400