

# 7288B.MP

Angular Contact Ball Bearings (single row, metric)



## Details:

### Main dimensions

d [mm]	440	$D_1$ [mm]	$\approx 655.3$
D [mm]	790	$r_{1,2}$ [mm]	7.5
B [mm]	112	$r_{3,4}$ [mm]	4
Weight [kg]	$\approx 250$	$\alpha_0$ [°]	40
$d_1$ [mm]	$\approx 583.3$	a [mm]	$\approx 314$

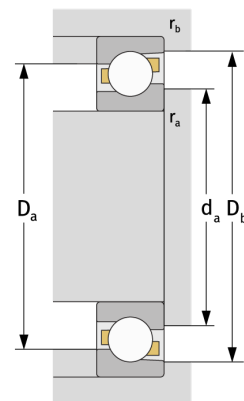
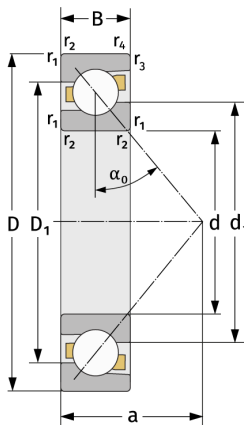

### Mating dimensions

$d_{a, \min}$ [mm]	472
$D_{a, \max}$ [mm]	758
$D_{b, \max}$ [mm]	773
$r_{a, \max}$ [mm]	6
$r_{b, \max}$ [mm]	3

### Calculation data

C [kN]	855
$C_0$ [kN]	1850
$C_u$ [kN]	36.7
$n_{th}$ [min <sup>-1</sup> ]	743
$n_g$ [min <sup>-1</sup> ]	930