

7356B.MP

Angular Contact Ball Bearings (single row, metric)



Details:

Main dimensions

d [mm]	280	D_1 [mm]	≈ 471.7
D [mm]	580	$r_{1,2}$ [mm]	6
B [mm]	108	$r_{3,4}$ [mm]	3
Weight [kg]	≈ 142	α_0 [°]	40
d_1 [mm]	≈ 397.1	a [mm]	≈ 234

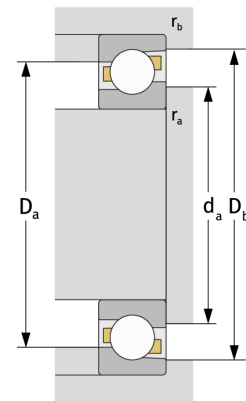
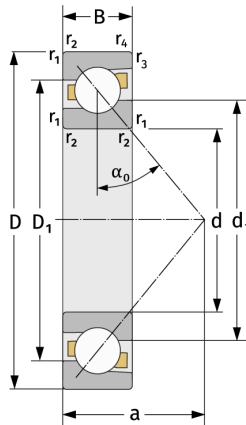

Mating dimensions		Calculation data	
$d_{a, \min}$ [mm]	306	C [kN]	750
$D_{a, \max}$ [mm]	554	C_0 [kN]	1260
$D_{b, \max}$ [mm]	566	C_u [kN]	30
$r_{a, \max}$ [mm]	5	n_{th} [min ⁻¹]	1038
$r_{b, \max}$ [mm]	2.5	n_g [min ⁻¹]	1500