

7360B.MP

Angular Contact Ball Bearings (single row, metric)



Details:

Main dimensions

d [mm]	300	D_1 [mm]	≈ 501.7
D [mm]	620	$r_{1,2}$ [mm]	7.5
B [mm]	109	$r_{3,4}$ [mm]	4
Weight [kg]	≈ 165	α_0 [°]	40
d_1 [mm]	≈ 427.1	a [mm]	≈ 247

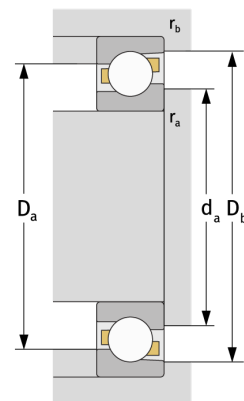
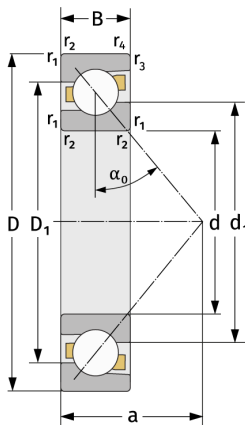

Mating dimensions		Calculation data	
$d_{a, \min}$ [mm]	332	C [kN]	780
$D_{a, \max}$ [mm]	588	C_0 [kN]	1370
$D_{b, \max}$ [mm]	603	C_u [kN]	31.7
$r_{a, \max}$ [mm]	6	n_{th} [min ⁻¹]	942
$r_{b, \max}$ [mm]	3	n_g [min ⁻¹]	1400