

# 7376B.MP

Angular Contact Ball Bearings (single row, metric)



## Details:

### Main dimensions

d [mm]	380	$D_1$ [mm]	$\approx 628.9$
D [mm]	780	$r_{1,2}$ [mm]	7.5
B [mm]	128	$r_{3,4}$ [mm]	4
Weight [kg]	$\approx 309$	$\alpha_0$ [°]	40
$d_1$ [mm]	$\approx 541.4$	a [mm]	$\approx 307$

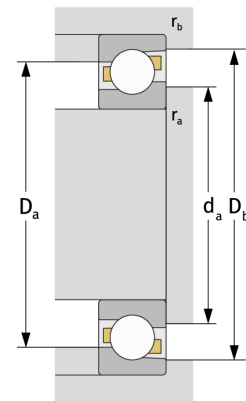
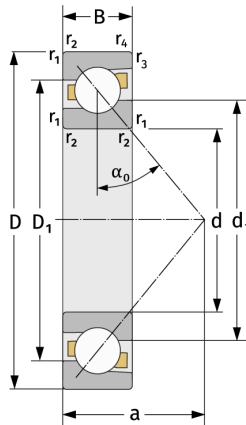

Mating dimensions		Calculation data	
$d_{a, \min}$ [mm]	412	C [kN]	1010
$D_{a, \max}$ [mm]	748	$C_0$ [kN]	2060
$D_{b, \max}$ [mm]	763	$C_u$ [kN]	42
$r_{a, \max}$ [mm]	6	$n_{th}$ [min <sup>-1</sup> ]	696
$r_{b, \max}$ [mm]	3	$n_g$ [min <sup>-1</sup> ]	1000