

# AH240/1060G

Withdrawal Sleeves



## Details:

### Main dimensions

d [mm]	1060	G [mm]	Tr1120
Weight [kg]	≈ 465		x8
d <sub>1</sub> [mm]	1000	G <sub>1</sub> [mm]	G1/4
B <sub>1</sub> [mm]	498	l <sub>G1</sub> [mm]	15
l <sub>G1</sub> [mm]	60	a [mm]	15

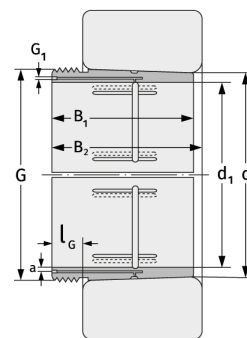

### Mating dimensions

### Calculation data