

AH241/710G

Withdrawal Sleeves



Details:

Main dimensions

d [mm]	710	G [mm]	Tr750x7
Weight [kg]	≈ 207		
d ₁ [mm]	670	G ₁ [mm]	G1/4
B ₁ [mm]	483	l _{G1} [mm]	15
l _{G1} [mm]	45	a [mm]	12

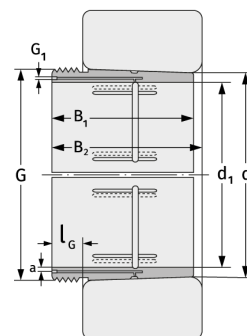

Mating dimensions

Calculation data