

AH30/710A

Withdrawal Sleeves



Details:

Main dimensions

d [mm]	710	G [mm]	Tr750x7
Weight [kg]	≈ 135		
d ₁ [mm]	670	G ₁ [mm]	G1/4
B ₁ [mm]	286	l _{G1} [mm]	15
l _{G1} [mm]	50	a [mm]	9

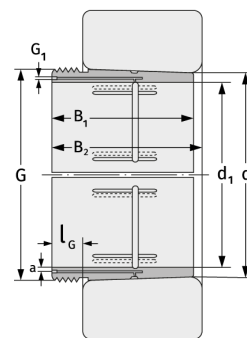

Mating dimensions

Calculation data