

# AH31/750A

Withdrawal Sleeves



## Details:

### Main dimensions

d [mm]	750	G [mm]	Tr800x7
Weight [kg]	≈ 236		
d <sub>1</sub> [mm]	710	G <sub>1</sub> [mm]	G1/4
B <sub>1</sub> [mm]	425	l <sub>G1</sub> [mm]	15
l <sub>G1</sub> [mm]	60	a [mm]	9

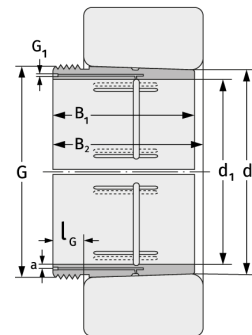

### Mating dimensions

### Calculation data