

AH32/1000A

Withdrawal Sleeves



Details:

Main dimensions

d [mm]	1000	G [mm]	Tr1060
Weight [kg]	≈ 603		x8
d ₁ [mm]	950	G ₁ [mm]	G1/4
B ₁ [mm]	630	l _{G1} [mm]	15
l _{G1} [mm]	70	a [mm]	9

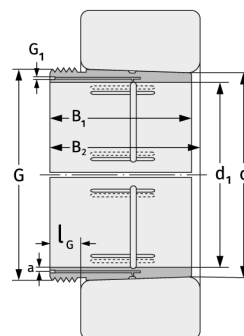

Mating dimensions

Calculation data