

# AH38/1120

Withdrawal Sleeves



## Details:

### Main dimensions

d [mm]	1120	B <sub>1</sub> [mm]	235
Weight [kg]	≈ 170	l <sub>G1</sub> [mm]	53
d <sub>1</sub> [mm]	1060	G [mm]	Tr1155 x8

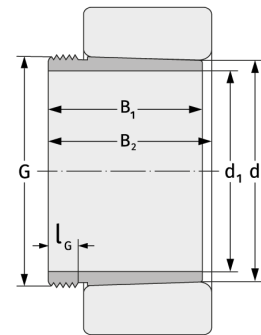

### Mating dimensions

### Calculation data