

AH39/630

Withdrawal Sleeves



Details:

Main dimensions

d [mm]	630	G [mm]	Tr655x6
Weight [kg]	≈ 62.8		
d ₁ [mm]	600	G ₁ [mm]	G1/4
B ₁ [mm]	210	l _{G1} [mm]	15
l _{G1} [mm]	40	a [mm]	9

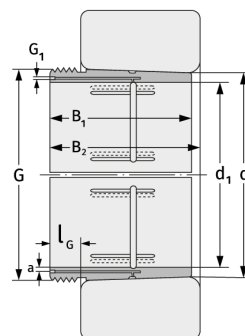

Mating dimensions

Calculation data