

H205

Clamping Sleeves



Details:

Main dimensions

d [mm]	25	B ₁ [mm]	26
Weight [kg]	≈ 0.07	B ₂ [mm]	8
d ₁ [mm]	20	G [mm]	M25x1.
d ₂ [mm]	38		5

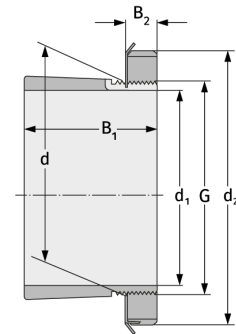

Mating dimensions

Containing components

Groove / shaft nut	KM5
Securing	MB5