

H2315

Clamping Sleeves



Details:

Main dimensions

d [mm]	75	B ₁ [mm]	73
Weight [kg]	≈ 1.05	B ₂ [mm]	15
d ₁ [mm]	65	G [mm]	M75x2
d ₂ [mm]	98		

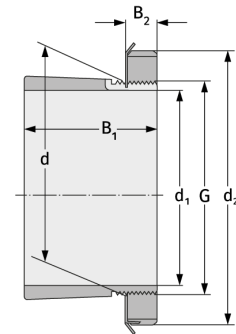

Mating dimensions

Containing components

Groove / shaft nut	KM15
Securing	MB15