

H24122

Clamping Sleeves



Details:

Main dimensions

d [mm]	110	B ₁ [mm]	99
Weight [kg]	≈ 2.45	B ₂ [mm]	21
d ₁ [mm]	100	G [mm]	M110x
d ₂ [mm]	145		2

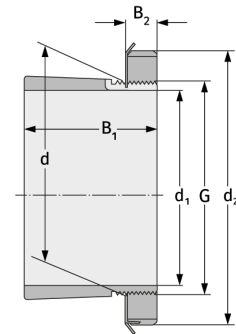

Mating dimensions

Containing components

Groove / shaft nut	KM22
Securing	MB22