

H306

Clamping Sleeves

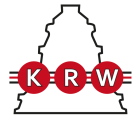

Details:

Main dimensions

d [mm]	30	B ₁ [mm]	31
Weight [kg]	≈ 0.109	B ₂ [mm]	8
d ₁ [mm]	25	G [mm]	M30x1.
d ₂ [mm]	45		5

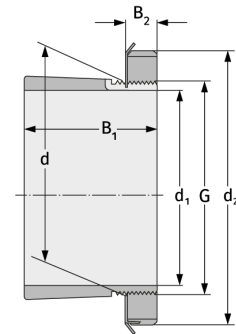

Mating dimensions

Containing components

Groove / shaft nut	KM6
Securing	MB6