

# H3120

Clamping Sleeves

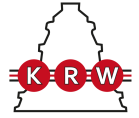

## Details:

### Main dimensions

d [mm]	100	B <sub>1</sub> [mm]	76
Weight [kg]	≈ 1.8	B <sub>2</sub> [mm]	20
d <sub>1</sub> [mm]	90	G [mm]	M100x
d <sub>2</sub> [mm]	130		2

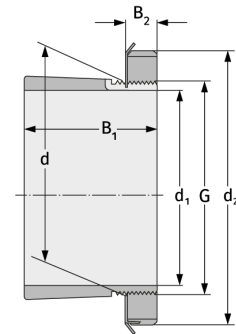

### Mating dimensions

### Containing components

Groove / shaft nut	KM20
Securing	MB20