

HM3056

Grooved Nuts



Details:

Main dimensions

Weight [kg]	≈ 6.78	B [mm]	38
G [mm]	Tr280x 4	b [mm]	24
		h [mm]	10
d ₁ [mm]	310		
d ₂ [mm]	330		

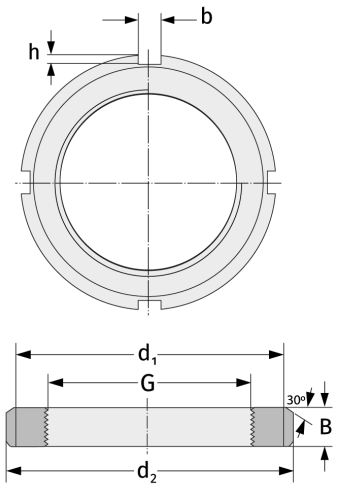

Mating dimensions

Containing components

Securing

MS3056