

Q2/500MPB

Four Point Contact Ball Bearings (metric)



Details:

Main dimensions

d [mm]	500	D_1 [mm]	≈ 758.7
D [mm]	920	$r_{1,2}$ [mm]	7.5
B [mm]	136	α_0 [°]	23
Weight [kg]	≈ 460	a [mm]	≈ 301
d_1 [mm]	≈ 661.3		

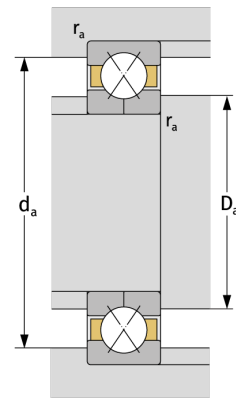
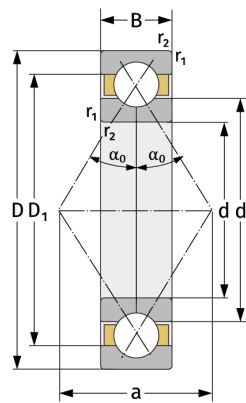

Mating dimensions

$d_{a, \min}$ [mm]	532
$D_{a, \max}$ [mm]	888
$r_{a, \max}$ [mm]	6

Calculation data

C [kN]	1920
C_0 [kN]	5500
C_u [kN]	103
n_{th} [min ⁻¹]	426
n_g [min ⁻¹]	1000