

# Q318MPB

Four Point Contact Ball Bearings (metric)



## Details:

### Main dimensions

d [mm]	90	$D_1$ [mm]	$\approx 155.5$
D [mm]	190	$r_{1,2}$ [mm]	3
B [mm]	43	$\alpha_0$ [°]	23
Weight [kg]	$\approx 6.64$	a [mm]	$\approx 59$
$d_1$ [mm]	$\approx 124.5$		

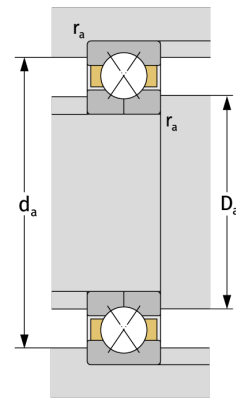
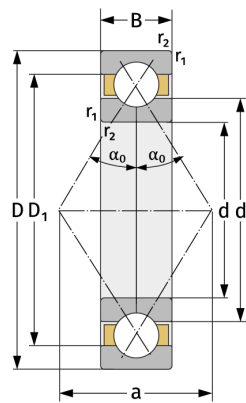

### Mating dimensions

$d_{a, \min}$ [mm]	104
$D_{a, \max}$ [mm]	176
$r_{a, \max}$ [mm]	2.5

### Calculation data

C [kN]	299
$C_0$ [kN]	307
$C_u$ [kN]	12.7
$n_{th}$ [min <sup>-1</sup> ]	3301
$n_g$ [min <sup>-1</sup> ]	6200