

# Q364MPB

Four Point Contact Ball Bearings (metric)



## Details:

### Main dimensions

d [mm]	320	$D_1$ [mm]	$\approx 538.3$
D [mm]	670	$r_{1,2}$ [mm]	7.5
B [mm]	112	$\alpha_0$ [°]	23
Weight [kg]	$\approx 222$	a [mm]	$\approx 210$
$d_1$ [mm]	$\approx 451.7$		

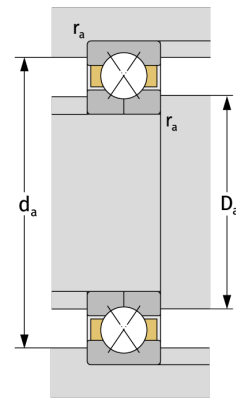
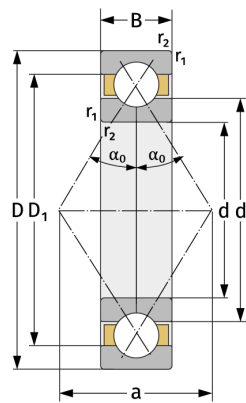

### Mating dimensions

$d_{a, \min}$ [mm]	352
$D_{a, \max}$ [mm]	638
$r_{a, \max}$ [mm]	6

### Calculation data

C [kN]	1450
$C_0$ [kN]	3230
$C_u$ [kN]	72.6
$n_{th}$ [min <sup>-1</sup> ]	631
$n_g$ [min <sup>-1</sup> ]	1600