

QJ1072MPA

Four Point Contact Ball Bearings (metric)



Details:

Main dimensions

d [mm]	360	D_1 [mm]	≈ 478.6
D [mm]	540	$r_{1,2}$ [mm]	5
B [mm]	82	α_0 [°]	35
Weight [kg]	≈ 72.5	a [mm]	≈ 315
d_1 [mm]	≈ 421.4		

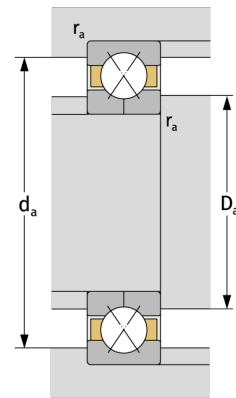
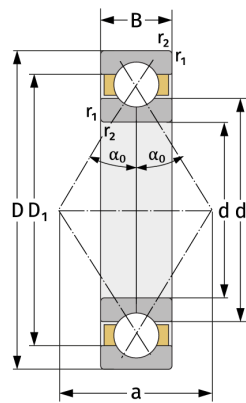

Mating dimensions

$d_{a, \min}$ [mm]	378
$D_{a, \max}$ [mm]	522
$r_{a, \max}$ [mm]	4

Calculation data

C [kN]	860
C_0 [kN]	1920
C_u [kN]	45.2
n_{th} [min ⁻¹]	856
n_g [min ⁻¹]	1800