

QJ1234MPA

Four Point Contact Ball Bearings (metric)



Details:

Main dimensions

d [mm]	170	D_1 [mm]	≈ 257.5
D [mm]	310	$r_{1,2}$ [mm]	4
B [mm]	62	α_0 [°]	45
Weight [kg]	≈ 23.2	a [mm]	≈ 240
d_1 [mm]	≈ 222.5		

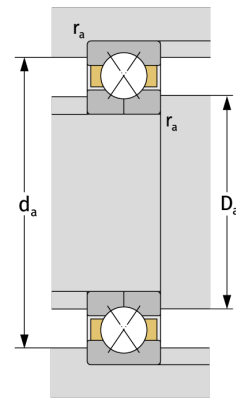
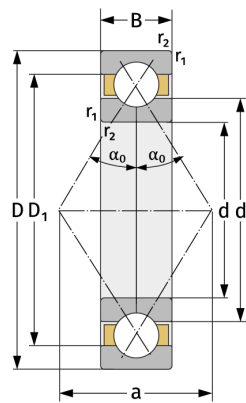

Mating dimensions

$d_{a, \min}$ [mm]	187
$D_{a, \max}$ [mm]	293
$r_{a, \max}$ [mm]	3

Calculation data

C [kN]	414
C_0 [kN]	615
C_u [kN]	19.5
n_{th} [min ⁻¹]	2226
n_g [min ⁻¹]	3500