

QJ19/710MPA

Four Point Contact Ball Bearings (metric)



Details:

Main dimensions

d [mm]	710	D_1 [mm]	≈ 867.1
D [mm]	950	$r_{1,2}$ [mm]	6
B [mm]	106	α_0 [°]	35
Weight [kg]	≈ 231	a [mm]	≈ 581
d_1 [mm]	≈ 792.9		

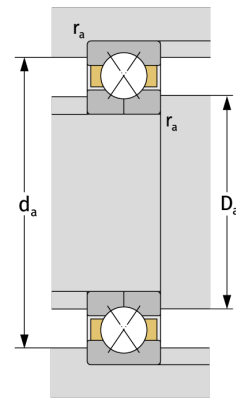
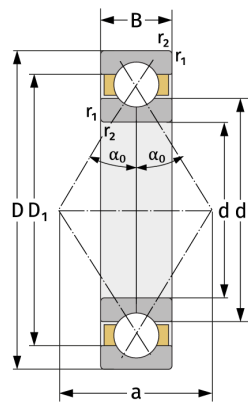

Mating dimensions

$d_{a, \min}$ [mm]	733
$D_{a, \max}$ [mm]	927
$r_{a, \max}$ [mm]	5

Calculation data

C [kN]	1400
C_0 [kN]	4480
C_u [kN]	78.5
n_{th} [min ⁻¹]	374
n_g [min ⁻¹]	820