

QJ360MPA

Four Point Contact Ball Bearings (metric)



Details:

Main dimensions

d [mm]	300	D_1 [mm]	≈ 501.8
D [mm]	620	$r_{1,2}$ [mm]	7.5
B [mm]	109	α_0 [°]	35
Weight [kg]	≈ 182	a [mm]	≈ 322
d_1 [mm]	≈ 418.2		

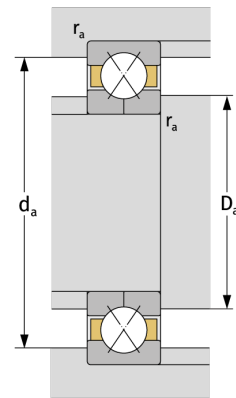
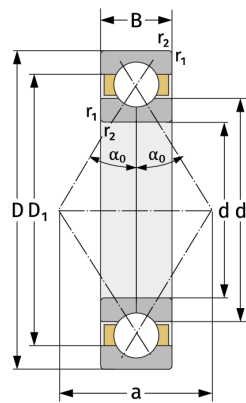

Mating dimensions

$d_{a, \min}$ [mm]	332
$D_{a, \max}$ [mm]	588
$r_{a, \max}$ [mm]	6

Calculation data

C [kN]	1200
C_0 [kN]	2550
C_u [kN]	59.3
n_{th} [min ⁻¹]	751
n_g [min ⁻¹]	1700