

# QJ419MPA

Four Point Contact Ball Bearings (metric)



## Details:

### Main dimensions

d [mm]	95	$D_1$ [mm]	$\approx 188.4$
D [mm]	240	$r_{1,2}$ [mm]	4
B [mm]	55	$\alpha_0$ [°]	35
Weight [kg]	$\approx 15$	a [mm]	$\approx 117$
$d_1$ [mm]	$\approx 146.6$		

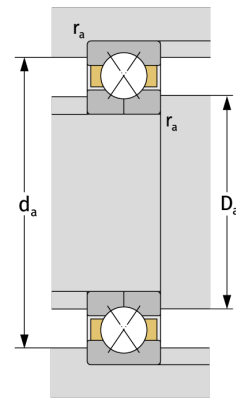
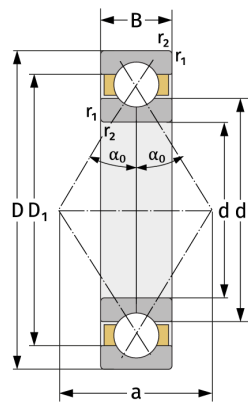

### Mating dimensions

$d_{a, \min}$ [mm]	115
$D_{a, \max}$ [mm]	220
$r_{a, \max}$ [mm]	3

### Calculation data

C [kN]	371
$C_0$ [kN]	414
$C_u$ [kN]	15.7
$n_{th}$ [min <sup>-1</sup> ]	2654
$n_g$ [min <sup>-1</sup> ]	5200