

# 160/560M

Deep Groove Ball Bearings (single row, metric)



## Details:

### Main dimensions

d [mm]	560	d <sub>1</sub> [mm]	≈ 652.6
D [mm]	820	D <sub>1</sub> [mm]	≈ 728.6
B [mm]	82	r <sub>1,2</sub> [mm]	6
Weight [kg]	≈ 160		

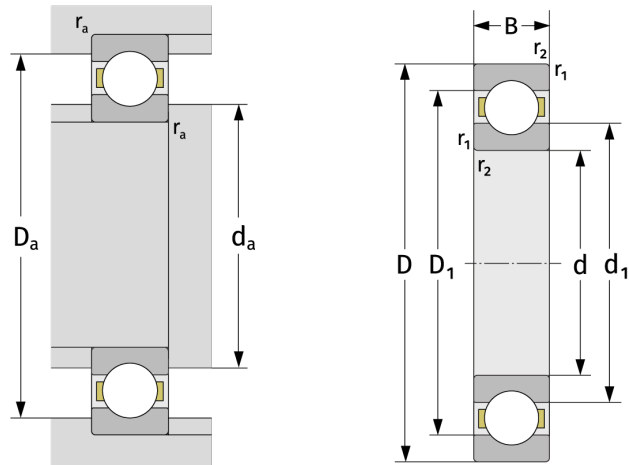

### Mating dimensions

d <sub>a,min</sub> [mm]	583
D <sub>a,max</sub> [mm]	797
r <sub>a,max</sub> [mm]	5

### Calculation data

C [kN]	570
C <sub>0</sub> [kN]	1140
C <sub>u</sub> [kN]	21.3
n <sub>th</sub> [min <sup>-1</sup> ]	861
n <sub>g</sub> [min <sup>-1</sup> ]	1200
f <sub>0</sub>	16,4