

# 609/950M

Deep Groove Ball Bearings (single row, metric)



## Details:

### Main dimensions

d [mm]	950	d <sub>1</sub> [mm]	≈
D [mm]	1250		1056.7
B [mm]	95	D <sub>1</sub> [mm]	≈
Weight [kg]	≈ 341		1144.7
		r <sub>1,2</sub> [mm]	6

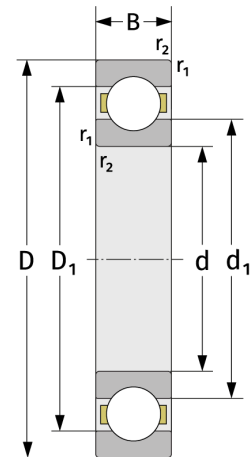
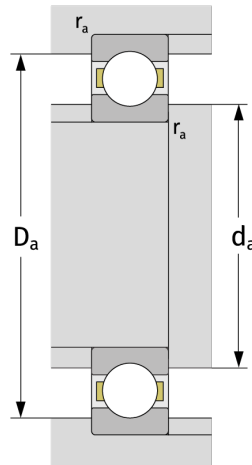

### Mating dimensions

d <sub>a,min</sub> [mm]	973
D <sub>a,max</sub> [mm]	1227
r <sub>a,max</sub> [mm]	5

### Calculation data

C [kN]	815
C <sub>0</sub> [kN]	2110
C <sub>u</sub> [kN]	30.8
n <sub>th</sub> [min <sup>-1</sup> ]	490
n <sub>g</sub> [min <sup>-1</sup> ]	610
f <sub>0</sub>	16