

619/630M

Deep Groove Ball Bearings (single row, metric)



Details:

Main dimensions

d [mm]	630	d ₁ [mm]	≈ 700.6
D [mm]	850	D ₁ [mm]	≈ 780.6
B [mm]	100	r _{1,2} [mm]	6
Weight [kg]	≈ 166		

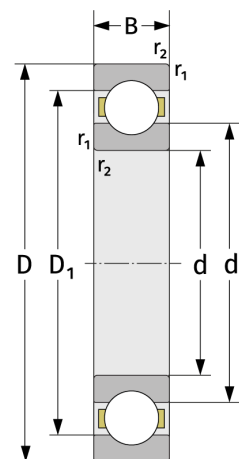
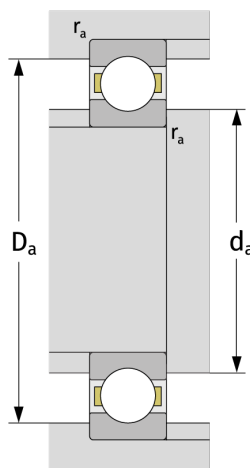

Mating dimensions

d _{a,min} [mm]	653
D _{a,max} [mm]	827
r _{a,max} [mm]	5

Calculation data

C [kN]	630
C ₀ [kN]	1330
C _u [kN]	23.9
n _{th} [min ⁻¹]	842
n _g [min ⁻¹]	1100
f ₀	16,4