

62922M

Deep Groove Ball Bearings (single row, metric)



Details:

Main dimensions

d [mm]	110	d ₁ [mm]	≈ 122.6
D [mm]	150	D ₁ [mm]	≈ 137.6
B [mm]	24	r _{1,2} [mm]	1.1
Weight [kg]	≈ 1.2		

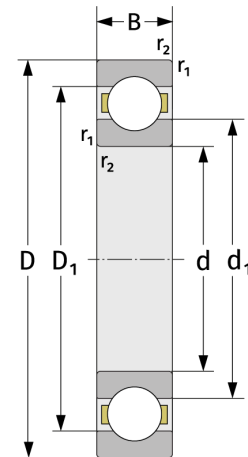
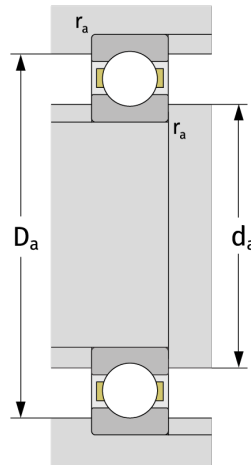

Mating dimensions

d _{a,min} [mm]	116
D _{a,max} [mm]	144
r _{a,max} [mm]	1

Calculation data

C [kN]	43.7
C ₀ [kN]	44.5
C _u [kN]	2
n _{th} [min ⁻¹]	4916
n _g [min ⁻¹]	7400
f ₀	16,5