

6422M

Deep Groove Ball Bearings (single row, metric)



Details:

Main dimensions

d [mm]	110	d ₁ [mm]	≈ 166.5
D [mm]	280	D ₁ [mm]	≈ 224.5
B [mm]	65	r _{1,2} [mm]	4
Weight [kg]	≈ 22.8		

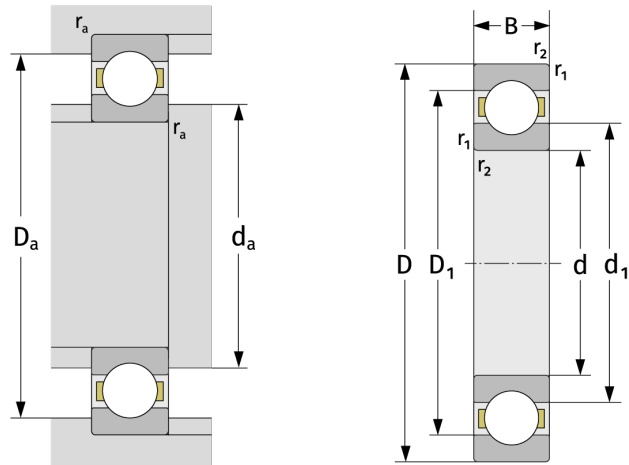

Mating dimensions

d _{a,min} [mm]	130
D _{a,max} [mm]	260
r _{a,max} [mm]	3

Calculation data

C [kN]	240
C ₀ [kN]	223
C _u [kN]	8.09
n _{th} [min ⁻¹]	3913
n _g [min ⁻¹]	4900
f ₀	13,1