

# 718/630MP

Angular Contact Ball Bearings (single row, metric)



## Details:

Main dimensions			
d [mm]	630	$D_1$ [mm]	$\approx 733.6$
D [mm]	780	$r_{1,2}$ [mm]	4
B [mm]	69	$r_{3,4}$ [mm]	1.5
Weight [kg]	$\approx 67.5$	$\alpha_0$ [°]	30
$d_1$ [mm]	$\approx 680.5$	a [mm]	$\approx 238$

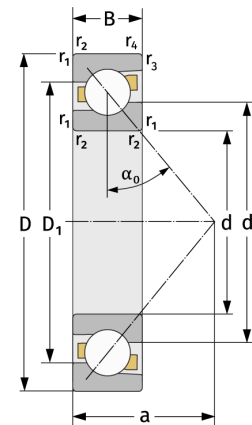
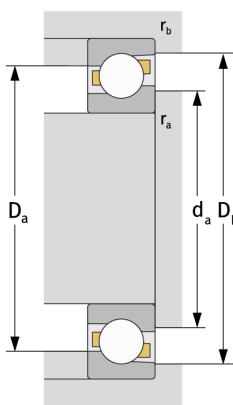

Mating dimensions		Calculation data	
$d_{a, \min}$ [mm]	644.6	C [kN]	535
$D_{a, \max}$ [mm]	765.4	$C_0$ [kN]	1250
$D_{b, \max}$ [mm]	773	$C_u$ [kN]	23.1
$r_{a, \max}$ [mm]	3	$n_{th}$ [min <sup>-1</sup> ]	584
$r_{b, \max}$ [mm]	1.5	$n_g$ [min <sup>-1</sup> ]	790